

# SIMPLO CAN 10W

## FEATURES

- Features an anti-glare design for improved visual comfort.
- Utilizes a high lumen COB chip and PMMA lens to provide uniform lighting output.
- AL6063 aluminum lamp body ensures effective heat dissipation.
- The special lens design achieves an anti-glare effect
- Easy to install and suitable for various applications, including recreational use.



## SPECIFICATION

### Basic Parameters

Dimension	Ø65*157
Voltage	AC230V
Power	10W
Power Factor	-
Lumen	850-1050
Beam Angle	24°/36°/60°
CCT	3000K, 4000K
Lifespan	50,000
CRI	80/90/97

### Driver Parameters

Output Voltage range	DC30-40V
Rated Output Current	220mA
Line Regulation	±5%
Setup, Rise Time	≤0.5S
Flickering Index	≤10%
Input Voltage	AC200-240V
Rated Input Voltage(V)	AC230V
Frequency	50/60Hz
Input Current	≤0.06A
Rated Input Current	≤0.05A
Power Factor	0.9
Efficiency	≥78%
No load wattage	<0.5W
Dimmer	Triac dimmers

### Technical Diagram

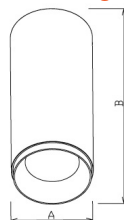

### Installation Instructions

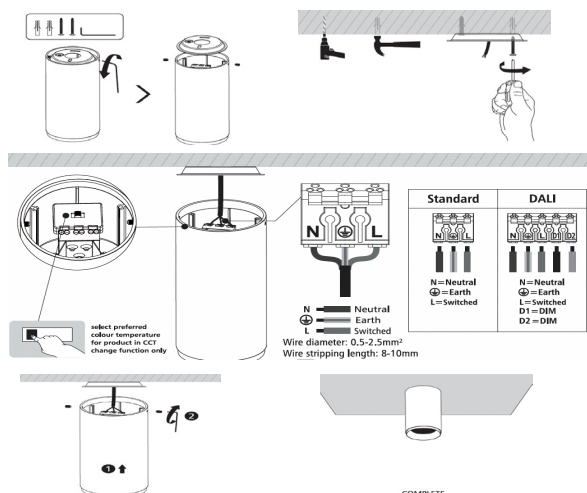

### Product Ordering

CODE	COLOUR	FINISH	STOCKED
SIMCAN-10-3000-W	3000K	White	S/O
SIMCAN-10-4000-W	4000K	White	S/O
SIMCAN-10-3000-B	3000K	Black	S/O
SIMCAN-10-4000-B	4000K	Black	S/O